

# LIGHT CONDUCTORS

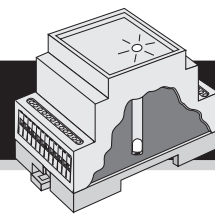

Ø 3mm light conductors for SMD or Leded Led's for transporting the light from the PCB to the front of the enclosure. - 5 different types can be combined into 20 different length from 11,8 mm to 51 mm including special length to fit most of Bernic's enclosures.

Foot 4.5 mm SMD

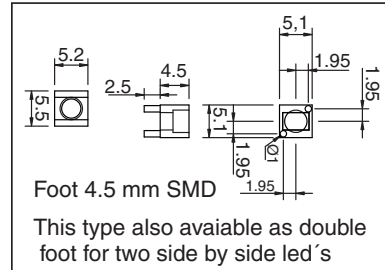
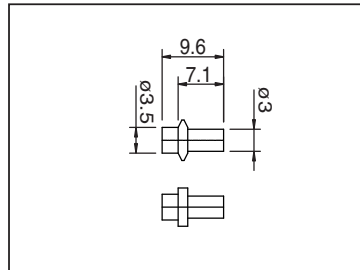
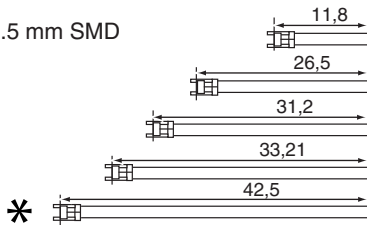

Foot 9.0 mm SMD

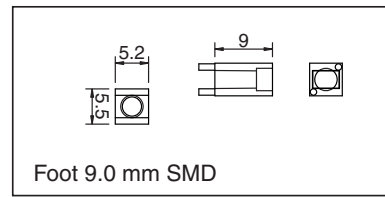
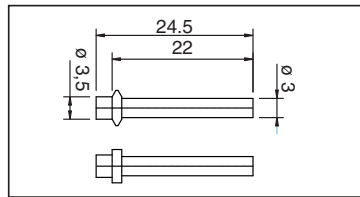
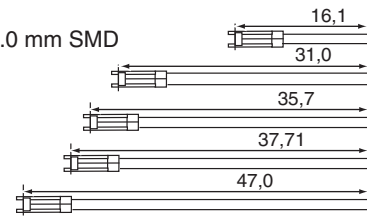

Foot 11.0 mm Leded

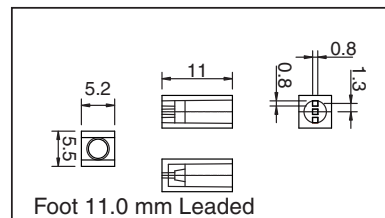
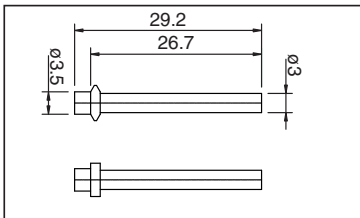
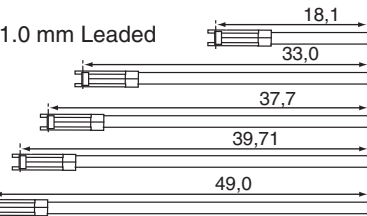

Foot 13.5 mm SMD

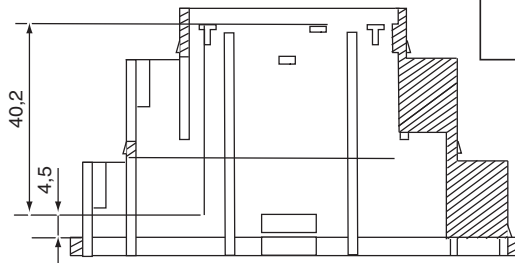
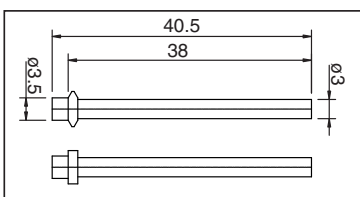
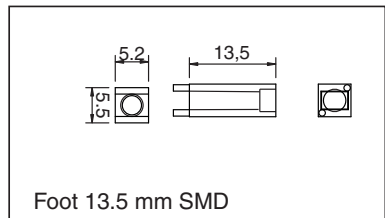
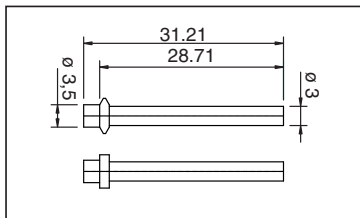
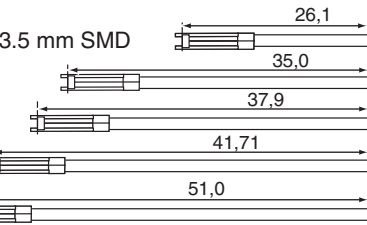

\* For Din Rail Enclosures from base PCB to front

|              |              |                |                |                |                |                |
|--------------|--------------|----------------|----------------|----------------|----------------|----------------|
| Total length | 4,5 mm foot  | 11,6           | 26,5           | 31,2           | 33,21          | 42,5 *         |
| Order Code:  | SMD          | p/n 4972301250 | p/n 4972301251 | p/n 4972301252 | p/n 4972301253 | p/n 4972301254 |
| Total length | 9,0 mm foot  | 16,1           | 31,0           | 35,7           | 37,71          | 47,0           |
| Order Code   | SMD          | p/n 4972301255 | p/n 4972301256 | p/n 4972301257 | p/n 4972301258 | p/n 4972301259 |
| Total length | 11,0 mm foot | 18,1           | 33,0           | 37,7           | 39,71          | 49,0           |
| Order Code   | LEADED       | p/n 4972301260 | p/n 4972301261 | p/n 497301262  | p/n 4972301263 | p/n 4972301264 |
| Total length | 13,5 mm foot | 20,6           | 35,5           | 40,2           | 42,21          | 51,5           |
| Order Code   | SMD          | p/n 4972301265 | p/n 4972301266 | p/n 4972301267 | p/n 4972301268 | p/n 4972301269 |

● All measurements are in mm.